



The Eagle Eye DY01 is a 2 Mega Pixel Mini PTZ camera with an IP66 environmental rating. This model is suitable for indoor and outdoor use where occasional PTZ functionality is needed. The camera comes preconfigured to securely operate with the Eagle Eye Cloud Security VMS and Eagle Eye CameraManager.

### Key Features

- > 4 Mega Pixel
- > Indoor/Outdoor Waterproof Dome
- > Durable All Aluminum Housing, IP66
- > Motorized lens 2.8-8mm
- > Wide Dynamic Range
- > Night Vision Smart IR, IR LEDs, 20m range
- > Triple RTSP Streams

### Dimension Drawing

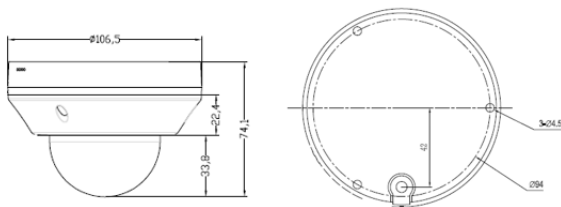

### Camera

Pixels	2 Mega Pixel
Resolutions	1920x1080/1280x720 @25/30fps
Lens	2.8-8mm
Night Vision	Smart IR LEDs with up to 20m range
Field of View	H: 94°-48°, V: 50°-27°
Dynamic Range	T-WDR and HLC/BLC
Digital Noise Reduction	2D/3D DNR and Defog
Digital Image Stabilization	Automatic
Applications	Best for small indoor areas: stock room, lobby, hallways, elevators, IT closets, storage rooms, entrances, interview rooms
Image Sensor	1/2.8" progressive scan CMOS
Iris	Fixed
Shutter Speed	1/5s to 1/20000s
Min Illumination	Color 0.01Lux; IR ON 0 Lux

### Digital Capabilities

Video Compression	H.265, H.264, and MJPEG
Audio Compression	G.711, RAW_PCM
Image Settings	Rotation, Saturation, Brightness, Contrast, Sharpness,
Corridor Mode	Yes

### Setup

Eagle Eye Cloud VMS	Preconfigured with secure password, plug and play
Camera Settings	Fully Integrated with Eagle Eye Cloud VMS and Eagle Eye CameraManager
Cyber Secure	Eagle Eye Verified

### Interface

Ethernet	Waterproof RJ-45 Female 10/100 Base-T
Audio	Built-in Mic
Edge Storage	Micro SD/SDHC/SDXC slot, Max 128GB

### Physical/Power

Power	DC12V/Power Over Ethernet (IEEE 802.3af)
Power Consumption	<10W
Operating Temperature	-20~50°C (-4~120°F)
Operating Humidity	0% - 90% RH
Ingress Protection	IP66
Approvals	CE/FCC
Dimensions	Φ 106.5 x 74.1mm (Φ4.19x2.92in)
Weight	400 grams (0.88lb)
Housing	All Aluminum

### Eagle Eye Part Numbers

EN-CDUY-001a	Outdoor Dome PTZ Adjustable, 4Mpix, IR, 3X Zoom, WDR, POE
EN-RRC01	Eagle Eye Camera Rapid Replacement
EN-CAWA-001	Eagle Eye Camera Wall Arm WA001 (DM07,DD05,DE02,DM08, DY01)
EN-CAPM-001	Eagle Eye Camera Pole Mount PM001 (BX002, BX003, BX004)